

Educating the Next Generation of Primary Care Dentists



LEARN. CARE COMMUNITY.



SDM Mission, Vision, and Values

Mission

Educate and train primary care dentists in a humanistic environment, emphasizing service among rural and underserved communities throughout the Northwest

Vision

Revolutionizing Community-Based Oral Health

Values

Excellence, Culture,
Compassion, Trust, Diversity,
Inclusion, Collaboration, Service

Number* of Dentists by County of Mailing Address (2022)

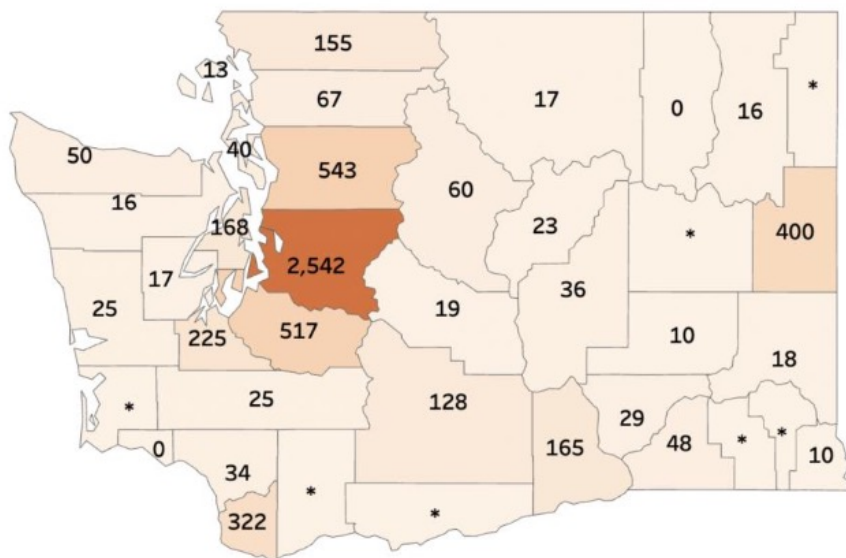

Number* of Dentists by County of Mailing Address per 100,000 Population (2022)

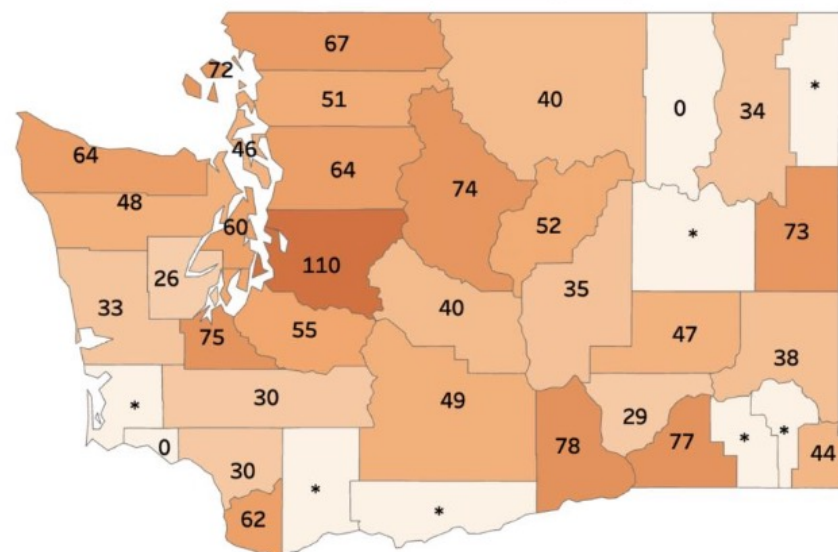

	DUA	%
National	7066	
AK	995	14.00
ID	262	3.71
MT	353	5.00
OR	401	5.68
WA	605	8.56
PNW	2616	37.00



June 2023

Our Goals



Preparing primary
care dentists for
practice in rural and
underserved areas

Address workforce
issues

Create a unique
educational program
based on community
partnerships

Accessible and
supportive
admissions process

Engage organized
dentistry and the
broader dental
community

Responsible
innovation in dental
education

Program Overview



4 Year Doctor of Dental Medicine Program



36 students per class



Year 1 – On-campus in Yakima



Year 2 to 4 – at one of
three community clinics



Extramural rotations in Year 4

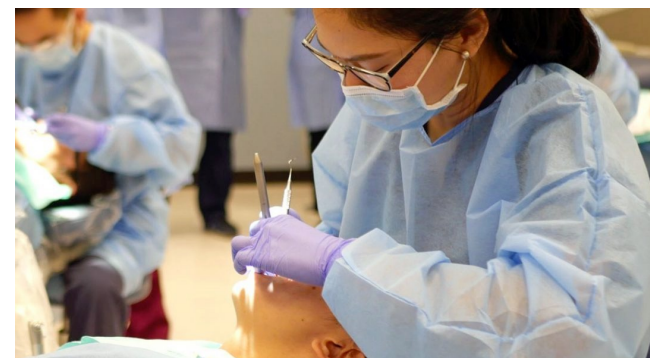

Academic Program

- Comprehensive and integrated biomedical and clinical sciences curriculum
 - Emphasis on interprofessional education and dental-medical integration
- Concurrent themes throughout the curriculum
 - Digital Dentistry
 - IPE/Dental-Medical Integration
 - Health Equity
 - Leadership



Partnerships



Delta Dental of Washington



**Pacific Northwest
University** of Health Sciences



**Yakima Valley
Farm Workers Clinic**

Delta Dental Equity Hall - Dental Simulation Area

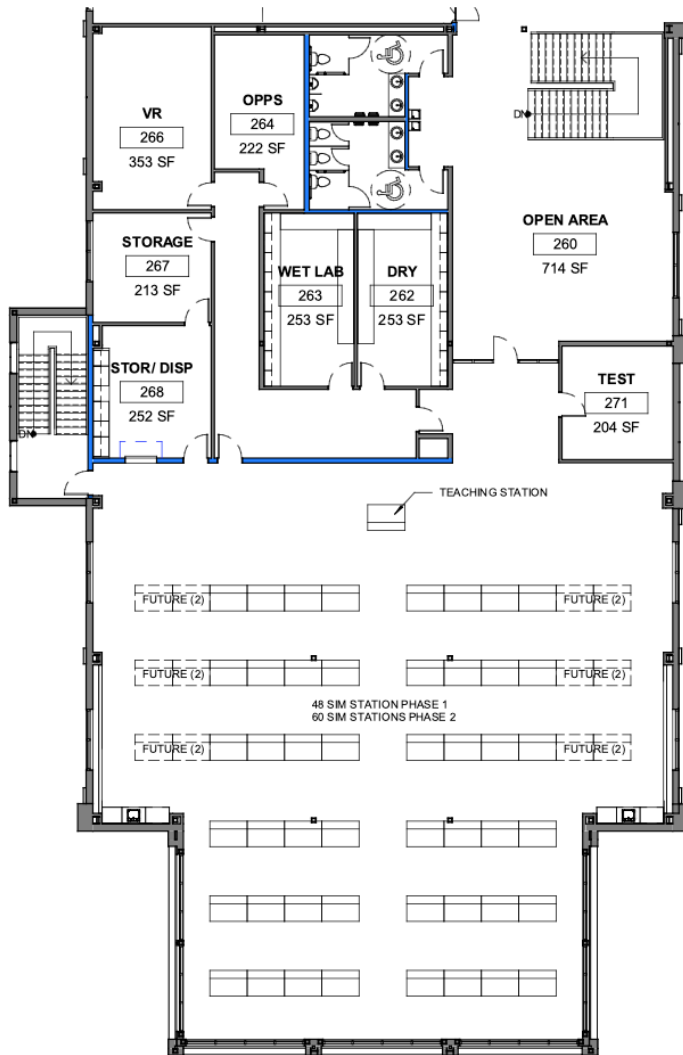

Community Clinics

- 22 Chairs/Clinic
- Lab support areas
- Classroom/Simulation/VR
- Staffing provided by FQHC
 - Dental Assistants
 - Sterilization
 - Reception
 - Clinic Manager



**Pacific Northwest
University** of Health Sciences





Second
Floor



Third
Floor

Tacoma Student Clinic



Completion: May 2026



Yakima Student Clinic



First Floor



Second Floor



Completion: May 2026



Kennewick Student Clinic



First Floor

Second Floor



**Yakima Valley
Farm Workers Clinic**



Completion: May 2026

Harnessing Technology



3D Printing



Virtual Reality Lab



CBCT



Teledentistry



Milling – Fixed and Removable Prosthodontics

Administration

Main Campus Faculty



Dr. Panagakos
Founding Dean



Dr. Pape
Associate Dean for
Academic Affairs



Dr. Reinke
Associate Dean for
Clinical Affairs



Ms. Sanchez
Executive Assistant
to the Dean



Ms. Brown
Asst. Director for
Academic Affairs



Ms. Anderson
Asst. Director for
Clinical Affairs



Ms. Orr
Administrative
Assistant



Ms. Turner
Director of
Student Success
and Engagement



Ms. Badillo
Dental Sim Lab
Manager



Dr. Ahuja
Assistant Professor
of Dentistry



Prof. Benetti
Assistant Professor
of Dental Hygiene



Dr. Crandall
Assistant Professor
of Dentistry



Dr. Dean
Associate Professor
of Dentistry



Dr. Domagalski
Assistant Professor
of Dentistry



Prof. Gutierrez
Associate Professor
of Dental Hygiene



Dr. Henprasert
Assistant Professor
of Dentistry
Prothodontics



Dr. Janis
Professor
of Dental Hygiene



Dr. Labbee
Assistant Professor
of Dentistry



Dr. Montiero
Assistant Professor
of Dentistry



Dr. Wright
Assistant Professor of Behavioral
Sciences and Director of Behavioral
Sciences and Scholarly Activity



Prof. Webber
Associate Professor
of Dental Hygiene



Dr. Grow
Professor
of Dentistry



Dr. Sharma
Assistant Professor
of Oral Radiology

Tacoma Faculty



Dr. Lee
Tacoma Clinic
Director



Dr. Chacon
Professor
Oral Surgery



Dr. Dunham
Assistant Professor
of Dentistry



Dr. Horton
Assistant Professor
Periodontics



Dr. Kim
Associate Professor
Orthodontics



Dr. Lamberton
Assistant Professor
of Dentistry



Dr. Madden
Professor
Periodontics



Dr. Mann
Assistant Professor
Prosthodontics



Dr. Olsson
Associate Professor
Endodontics



Dr. Titus
Professor
of Dentistry



Dr. Ritacca
Assistant Professor
of Dentistry



Dr. Strong
Assistant Professor
of Dentistry

Kennewick Faculty



Dr. Storey
Kennewick Clinic
Director



Dr. Alkanan
Assistant Professor
Periodontics



Dr. Bradle
Assistant Professor
of Dentistry



Dr. Fang
Associate Professor
Orthodontics



Dr. Lucier
Assistant Professor
Pediatrics



Dr. Grow
Professor of
Dentistry



Dr. Toponce
Assistant Professor
Oral Surgery



Dr. Weatherill
Assistant Professor
of Dentistry



Dr. Crandall
Assistant Professor
of Dentistry

Yakima Faculty



Dr. Bothell
Assistant Professor
of Dentistry



Dr. Hudson
Associate
Professor
Oral Surgery



Dr. Lucier
Assistant Professor
Pediatrics



Dr. Schafer
Assistant Professor
Endodontics



Dr. Yassin
Associate Professor
Periodontics

Student Recruitment

- Focus on applicants from Washington and the 4-state NW region (MT, ID, OR, AK)
- Rural/Underserved Areas Nationally
- Strong demonstrated desire to practice in an underserved area
- Active Outreach Program

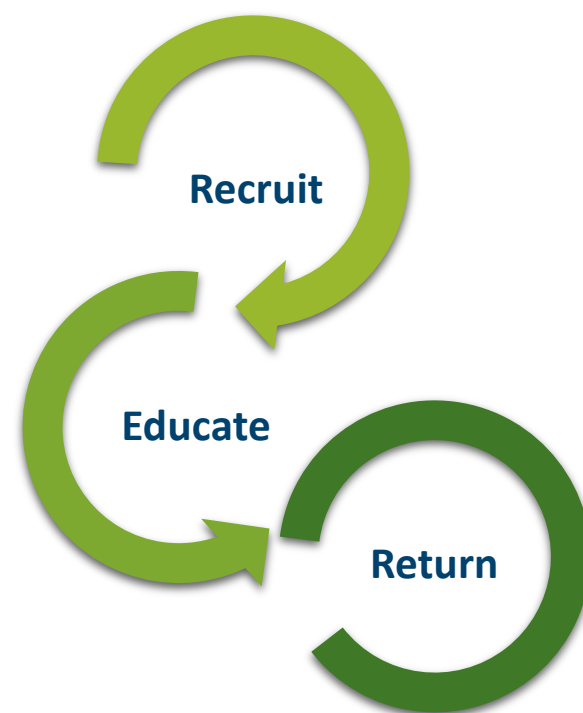

Class of 2029



Gender:

23 Females (64%)

13 Males (36%)

Prior Dental Experience:

12 Dental Assistants

9 Dental Hygienists

Where are they from:

Washington 22

Montana 3

Florida 2

California 2

One each from UT, ID, CO,
TX, OK, AK, MI

**From Rural and Medically
Underserved Areas: 72%**



GPA:

Overall: 3.40

Sciences: 3.31

Race (self-reported):

Hispanic 15

Native American/Alaska Native 4

Black 6

Asian 2

White 23

SDM Details

- Tuition and Fees:
 - \$77,250 tuition for the Class of 2030 (est.)
 - \$10K fees (est.)
- DAT not required
- No advanced standing program at this time for foreign-trained dentists
- AADSAS Portal Opens May 13th, 2026
- Interviews begin July 18th
- The last day the SDM will accept applications from AADSAS is October 17th



SDM Development Timeline

